



tempio<sup>®</sup> SYSTEMS













**tempio<sup>®</sup> SYSTEMS**

# VENTILATED FAÇADE FACHADA VENTILADA



tempio®[projects] Jan Dang Library, South Korea

## TEMPIO VENTILATED FAÇADE ADVANTAGES VENTAJAS DE LA FACHADA VENTILADA TEMPIO

- |   |  |
|---|--|
|  _Energetic costs 25-40% reduction<br>_Reducción del gasto energético entre el 25-40%            |  _0% wastewater discharged<br>_0% de aguas residuales vertidas                          |
|  _Increased thermal and acoustic comfort<br>_Aumento del confort térmico y acústico              |  _Low CO <sub>2</sub> emissions<br>_Mínima emisión de CO <sub>2</sub>                   |
|  _No water condensation and waterproofness<br>_Eliminación del agua condensada e impermeabilidad |  _Waste material recycling<br>_Reciclaje del material sobrante                          |
|  _Passive ventilation and thermal isolation<br>_Ventilación pasiva y aislación térmica           |  _Direct application without creating debris<br>_Aplicación directa sin crear escombros |
|  _Double wall<br>_Doble pared  |  _Piece by piece replaceable system<br>_Sistema reemplazable pieza por pieza            |
|  _Self-cleaning with rainwater<br>_Autolimpiable con agua de lluvia                              |  _Revaluation of property<br>_Revalorización del inmueble                               |
|  _Resistant to the passage of time<br>_Resistente al paso del tiempo                             |  _Hidden crevices and conductions<br>_Grietas y paso de conducciones ocultas            |



tempio®[projects] Cementos Benidorm, Spain

The ceramic material is extruded porcelain stoneware which is coloured throughout the whole body, with a natural or glazed finish in a wide range of colours, fired at a temperature of 1200°C.

Leading European laboratories have certified the physical characteristics of this material:

- Frost-resistant material pursuant to standard UNE EN 10545 withstanding 100 frost/defrost cycles.
- Non-combustible material.
- High impact resistance >0,75 pursuant to standard UNE EN 10545.
- Non-variable material, easy to clean.

En cuanto al material cerámico, se trata de un gres porcelánico extruído color en masa, con acabado natural o esmaltado en una amplia gama de colores y cocido a una temperatura de 1200°C.

Los mejores laboratorios europeos certifican las cualidades físicas del material:

- Material resistente al hielo según norma UNE EN 10545 soportando 100 ciclos de hielo/deshielo.
- Se trata de un material no combustible.
- Importante resistencia a golpes >0,75 según norma UNE EN 10545.
- Material invariable y fácil de limpiar.

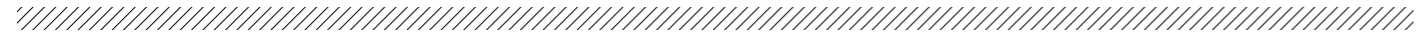

FK-16  
FK-20



FK-L 1/16  
FK-L 1/20



FK-1BA 5/16



FK-2B 5/16



FK-L 2/16



FK-L 3/16



FK-1BB 5/16



FK-L 59/16



FK-L 4/16



FK-O 8/20

Height module/inch Alto módulo/mm	FK-16	FK-20	FK-L 1/16	FK-L 1/20	FK-L 2/16	FK-L 3/16	FK-L 4/16	FK-O 8/20	FK-L 59/16	FK-1BA 5/16	FK-1BB 5/16	FK-2B 5/16
200 - 7,87"	■	■	■						■			
240 - 9,44"	■											
250 - 9,84"	■											
280 - 11,02"	■											
300 - 11,81"	■	■	■	■	■		■	■		■	■	■
310 - 12,20"		■										
315 - 12,40"	■											
340 - 13,38"	■											
350 - 13,78"	■	■	■				■					
380 - 14,96"	■											
400 - 15,74"	■	■	■	■			■					
450 - 17,71"	■											
500 - 19,68"	■	■	■									
510 - 20,07"	■											
545 - 21,45"		■	■									
600 - 23,62"		■										
length piece/mm largo pieza/mm	< 1200	< 1500	< 1200	< 1500	< 1200	< 1200	< 1200	< 1500	< 1200	< 1200	< 1200	< 1200

# FK SYSTEM

## FK PERSPECTIVE | PERSPECTIVA FK

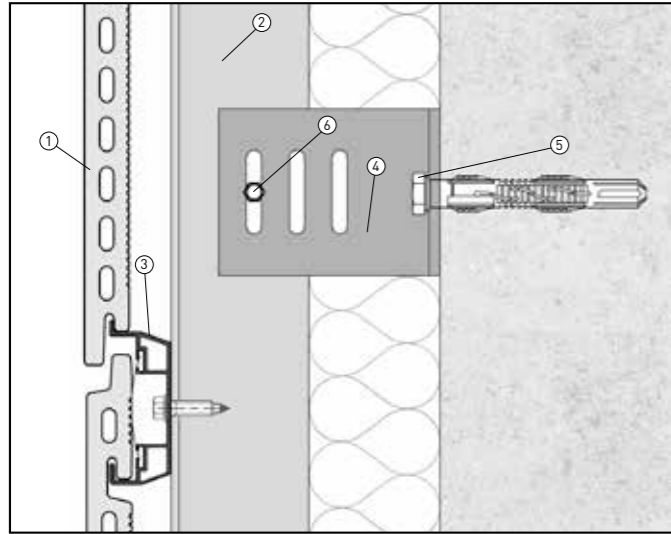

- |   |  |
|---|--|
| 1_ <b>Tempio tile</b><br>Pieza Tempio             | 5_ <b>Anchorage</b><br>Anclaje                         |
| 2_ <b>Vertical T profile</b><br>Perfil T vertical | 6_ <b>Fixet to sliding point</b><br>Fijación corredera |
| 3_ <b>Horizontal profile</b><br>Perfil horizontal | 7_ <b>Insulating layer</b><br>Aislante                 |
| 4_ <b>Bracket</b><br>Ménsula                      | 8_ <b>Termination profile</b><br>Perfil de terminación |

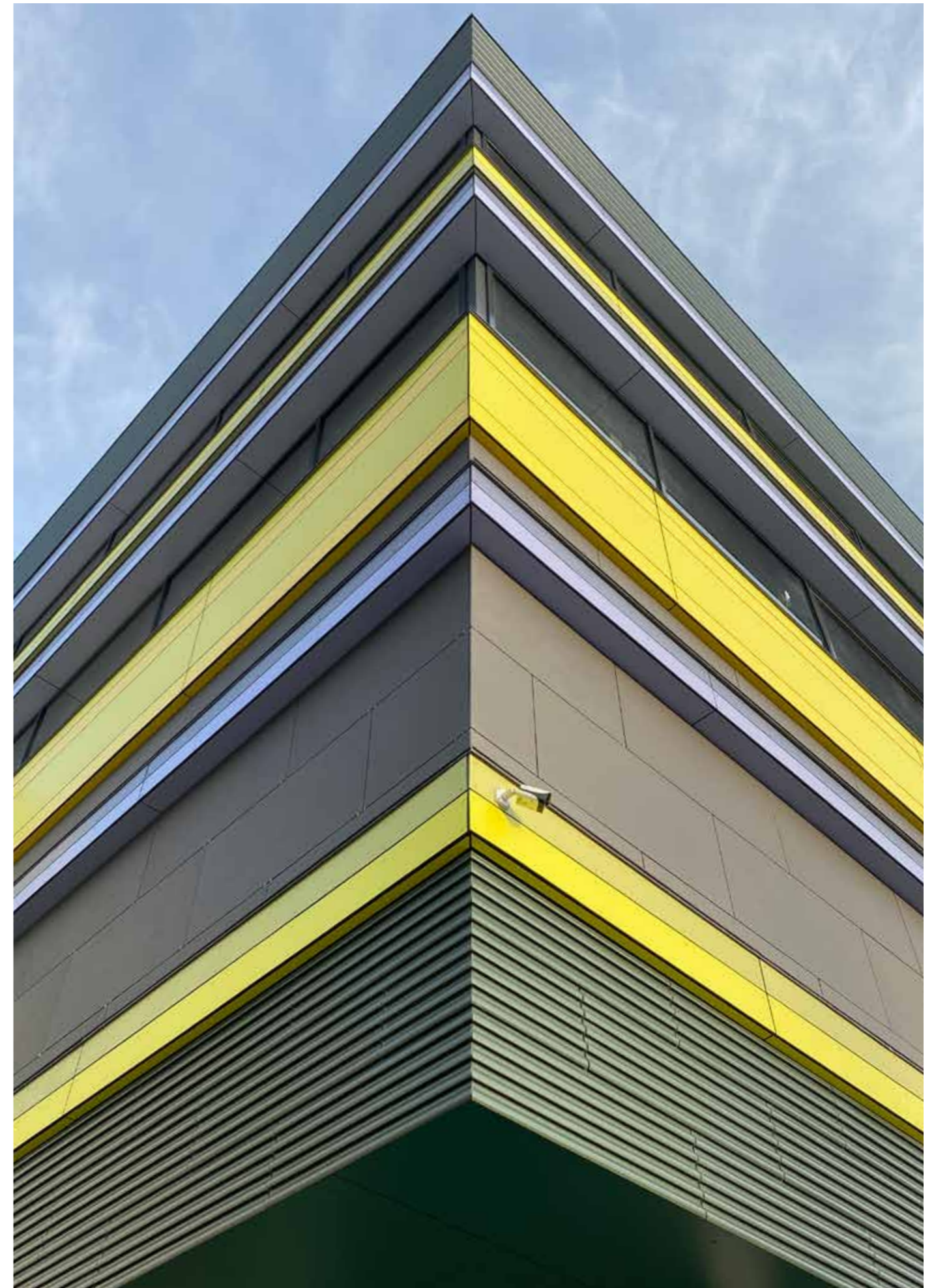
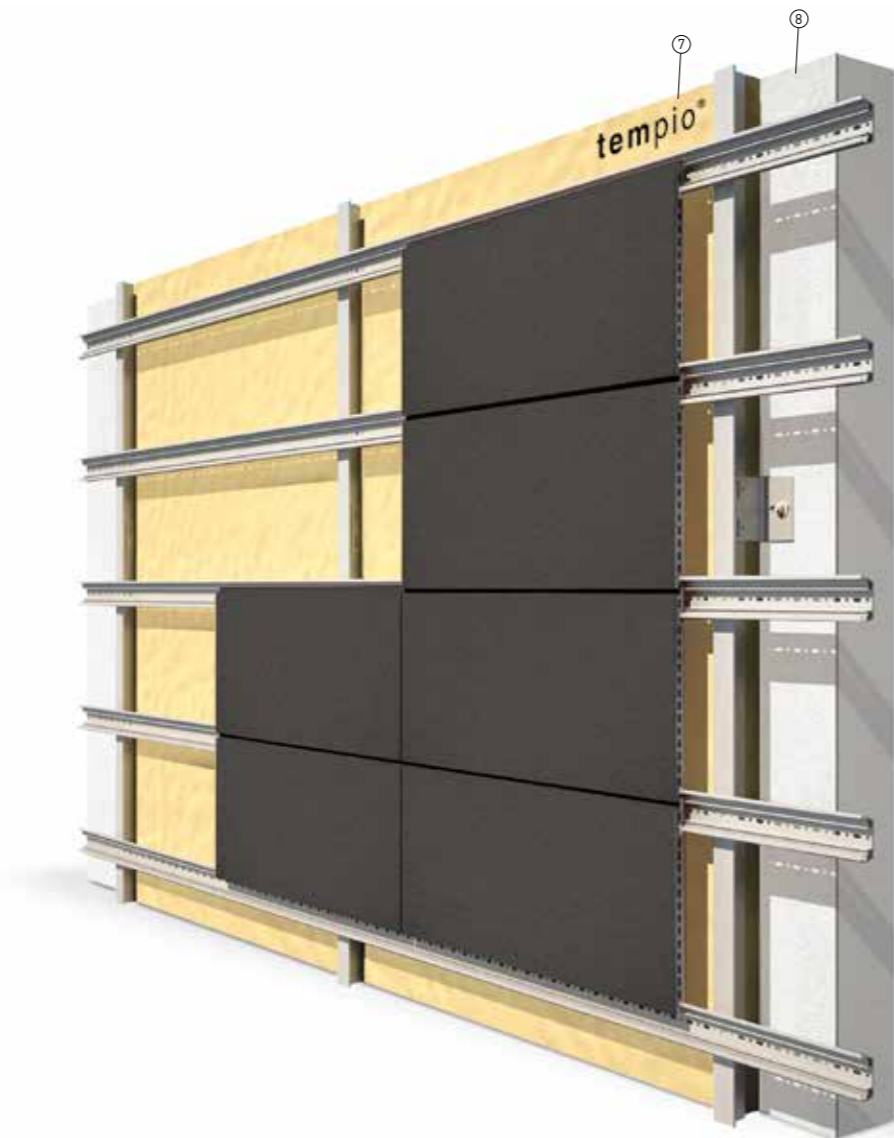

tempio®[projects] Bergu Music and Arts Elementary School, Skolas iela 8, Upesciems, Garkalnes novads, Leton



**PROJECT**  
Original Sokos Hotel

**LOCATION**  
Kupittaa, Tuku, Finland

**ARCHITECT**  
Haroma & Partners Oy

**PIECE**



FK-16

**COLOURS**



Black Seattle E1185



Green Glasgow EB3470





**PROJECT**  
M Carnegie Building

**LOCATION**  
316 Neerim Road Carnegie, Melbourne

**ARCHITECT**  
T-A Square Architects

---

**PIECE**



FK-16

---

**COLOURS**



White Madrid EM2220







**PROJECT**  
Just Järvenpään Sairaala

**LOCATION**  
Järvenpää, Finland

**ARCHITECT**  
UKI Arkkitehdit

**PIECE**



FK-16

**COLOURS**



Red R25-19





**PROJECT**  
Heka Teerisuontie 27

**LOCATION**  
Malmi, Helsinki, Finland



**ARCHITECT**  
Eeva Kilpiö / A6

**PIECE**



FK-16

**COLOURS**

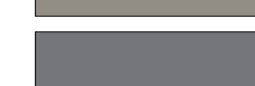
	Red R25-25
	Brown BR2-08
	Grey GR1-10
	Grey GR2-20



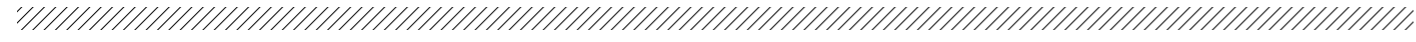

FS-20 | FS-24 | FS-28



FS-L 2/20 | FS-L2/24 | FS-L2/28

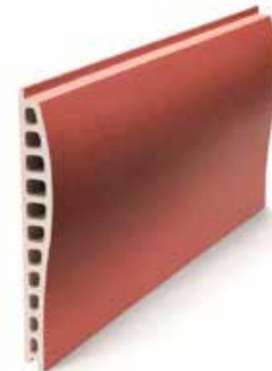

FS-D 24



FS-L 4/24



FS-T 7/28



FS-D 5/23



FS-L 5/28



FS-L 7/28



FS-LP 2/28



FS-2B/20 | FS-2B-28



FS-L 18/24



FS-L 3/28



FS-LP 3/28

Height module/inch Alto módulo/mm	FS-20	FS-24	FS-28	FS-L 2/20	FS-L 2/24	FS-L 2/28	FS-T 7/28	FS-D 5/23	FS-LP 2/28	FS-2B/20	FS-2B/28	FS-L 3/28	FS-LP 3/28	FS-D 24	FS-L 4/24	FS-L 5/28	FS-L 7/28
200 - 7,87"	■	■	■														
225 - 8,86"	■																
250 - 9,84"	■	■	■														
280 - 11,02"	■	■															
300 - 11,81"	■	■	■	■	■	■	■	■	■	■	■			■			
350 - 13,78"				■													
375 - 14,76"	■																
400 - 15,74"	■	■	■									■	■				■
450 - 17,71"	■																
500 - 19,68"	■	■		■											■		
600 - 23,622"			■													■	
length piece/mm largo pieza/mm	< 1500	< 1500	< 1500	< 1500	< 1500	< 1500	< 1500	< 1500	< 1500	< 1500	< 1500	< 1500	< 1500	< 1500	< 1500	< 1500	< 1500
weigh/peso - kg/m <sup>2</sup>	33	42	48	32	39	48	37	30	42	39	52	45	42	38.5	40	45.5	44

# FS SYSTEM

## FS PERSPECTIVE | PERSPECTIVA FS

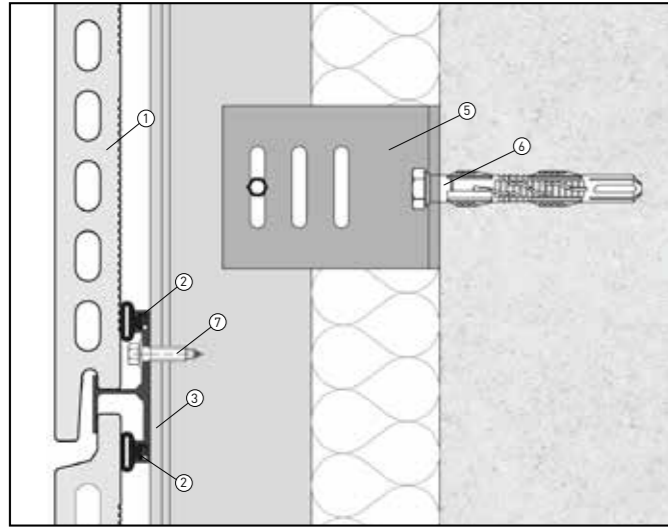

- |  |  |
|--|--|
| 1_ <b>Tempio tile</b><br>Pieza Tempio                        | 5_ <b>Bracket</b><br>Ménsula                     |
| 2_ <b>Clip</b><br>Grapa                                      | 6_ <b>Anchorage</b><br>Anclaje                   |
| 3_ <b>Main T profile</b><br>Peril en T                       | 7_ <b>Self screwing</b><br>Tornillo autoroscante |
| 4_ <b>Vertical joint profile</b><br>Perfil vertical de junta | 8_ <b>Insulating layer</b><br>Aislante           |



tempio®[projects] KTNG, Busan City, South Korea



**PROJECT**  
200 George Street

**LOCATION**  
Sidney, Australia

**ARCHITECT**  
FJMT Sydney

---

**PIECE**



FS-L 5/30

---

**COLOURS**



White W2-07





**PROJECT**  
Songdo Convensia





**LOCATION**  
Central-ro, Yeonsu-gu, Incheon, South Korea

**PIECE**



FS-20

**COLOURS**

	White W2-07
	Yellow Y00-05
	Red R05-05
	Red R25-25





PROJECT  
Gwangjin Police





LOCATION  
Central-ro, Yeonsu-gu, Incheon,  
Republic of Korea

PIECE



FS-20

COLOURS

	White W2-07
	Yellow Y00-05
	Red R05-05
	Red R25-25





**PROJECT**  
FITI Testing & Research Institute

**LOCATION**  
Gangseo-gu, Seoul, Republic of Korea

**PIECE**



FS-22-L

**COLOURS**





# HIGH PROFILE PIECES



FF-C30



FF-T 1/60

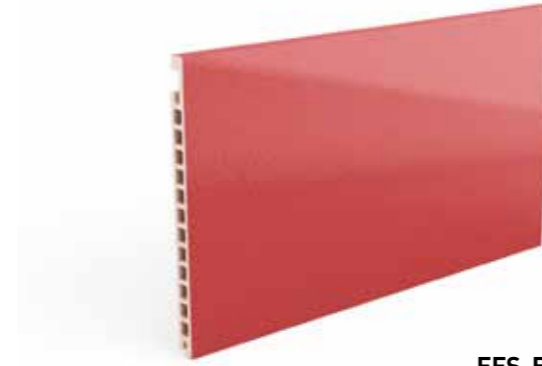

FFS-ESP-28



FF-D 5/23.1



FFW-75A



FFNr66



FF-D 5/23



FF-E 215X197



FF3D T



FF-1B



3D corner



FF-K 45,5/R500



FF-K 30/R300



Soft



Tokyo



FF-C 9/65



FF-X44



**PROJECT**  
Justice House

**LOCATION**  
Zugdidi, Georgia

**PIECE**



FF-C9/65

**COLOURS**



White Formentera EB3210





PROJECT  
D-Tower

LOCATION  
Songdo, Korea

ARCHITECT  
Samoo Architects & Engineers

PIECE



3D Corner

COLOURS



Yellow Y125-15





**PROJECT**  
22 Viviendas

**LOCATION**  
Cartagena, Spain

**ARCHITECT**  
Martín Lejarraga Arquitectos

**PIECE**



FF-O 3/40

**COLOURS**



Blue Volga EB3315



# BAGUETTES



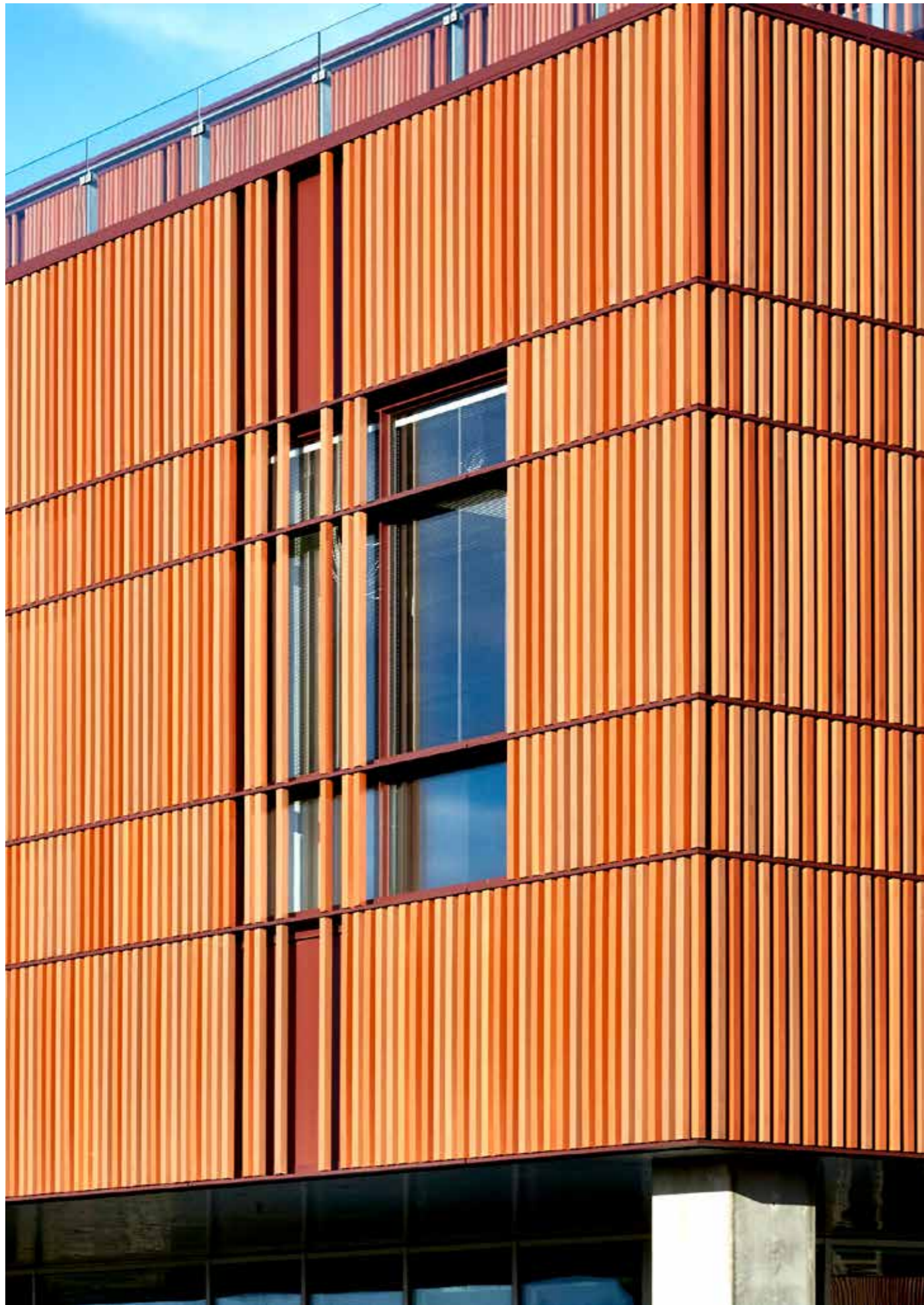

## TEMPIO BAGUETTES ADVANTAGES

### VENTAJAS DE LAS BAGUETTES DE TEMPIO

#### EXTERIOR APPLICATION | APLICACIÓN EXTERIOR

- \_Solar shading\_Protección solar
- \_Horizontal and vertical orientation\_Orientación vertical y horizontal
- \_Suitable for any building size\_Apto para cualquier tamaño de edificio
- \_Venetian blind slats with ceramics\_Celosía con lamas de cerámica
- \_Window sill and wall copings\_Alfeizares de ventanas y coronación de paredes
- \_Profiles with hollow chamfers\_Perfiles con cámaras huecas
- \_Customized designed substructure\_Subestructura especialmente diseñada

- \_Customized pieces\_Personalización de piezas
- \_Wide variety of natural terracotta and glazed colours with gloss or matt finish. On request, other finishing colors can be produced\_Gran variedad de colores naturales y esmaltados en brillo o mate. También fabricamos colores bajo demanda.

#### INDOOR APPLICATION | APLICACIÓN INTERIOR

- \_Ambient Separation\_Separación de ambientes
- \_Coating for interior walls and ceilings\_Revestimiento de techos y paredes interiores
- \_Ephemeral architecture\_Arquitectura efímera



# BAGUETTE SYSTEM

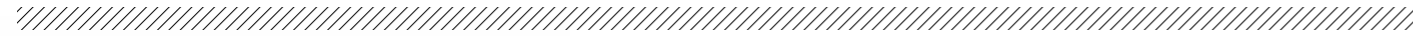

**B-d50**



**B-d110**



**BO-160x50**

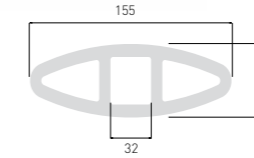

**BO-300x62**

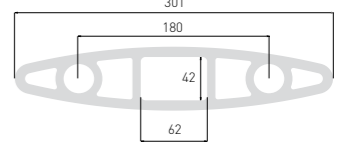

**B-5x5**

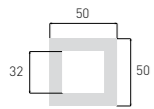

**B-6x6**

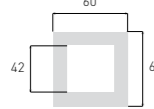

**B-7x7**

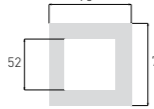

**B-5x5 curvo**

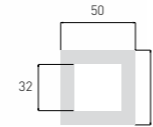

**BO-200x50**

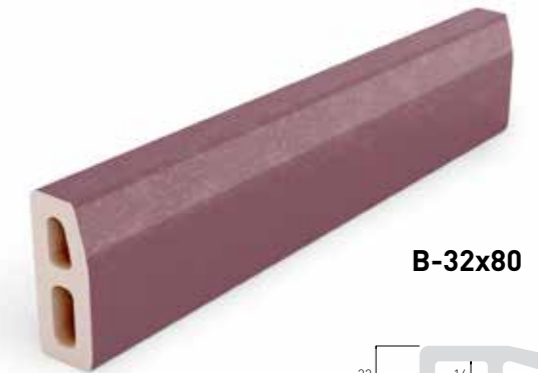
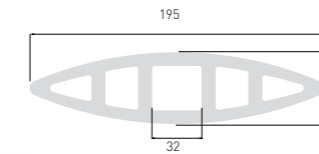

**B-32x80**

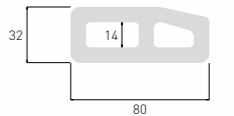

**B-5x8 r50**

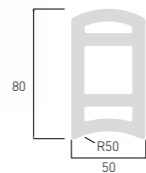

**B-5x8**

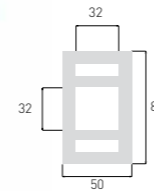

**B-5x13**

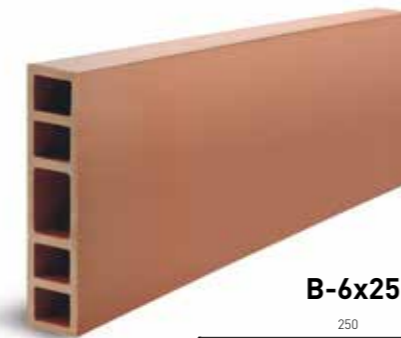
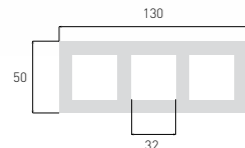

**B-6x25**

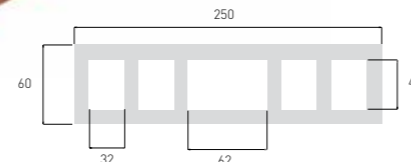

**BR0-49x75**

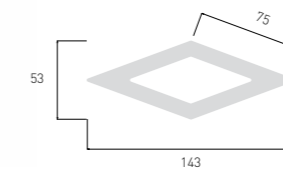

**BGR-28x150**

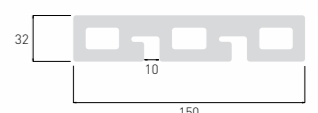

# BAGUETTE SYSTEM

## FIXATION DETAIL | DETALLE DE FIJACIÓN

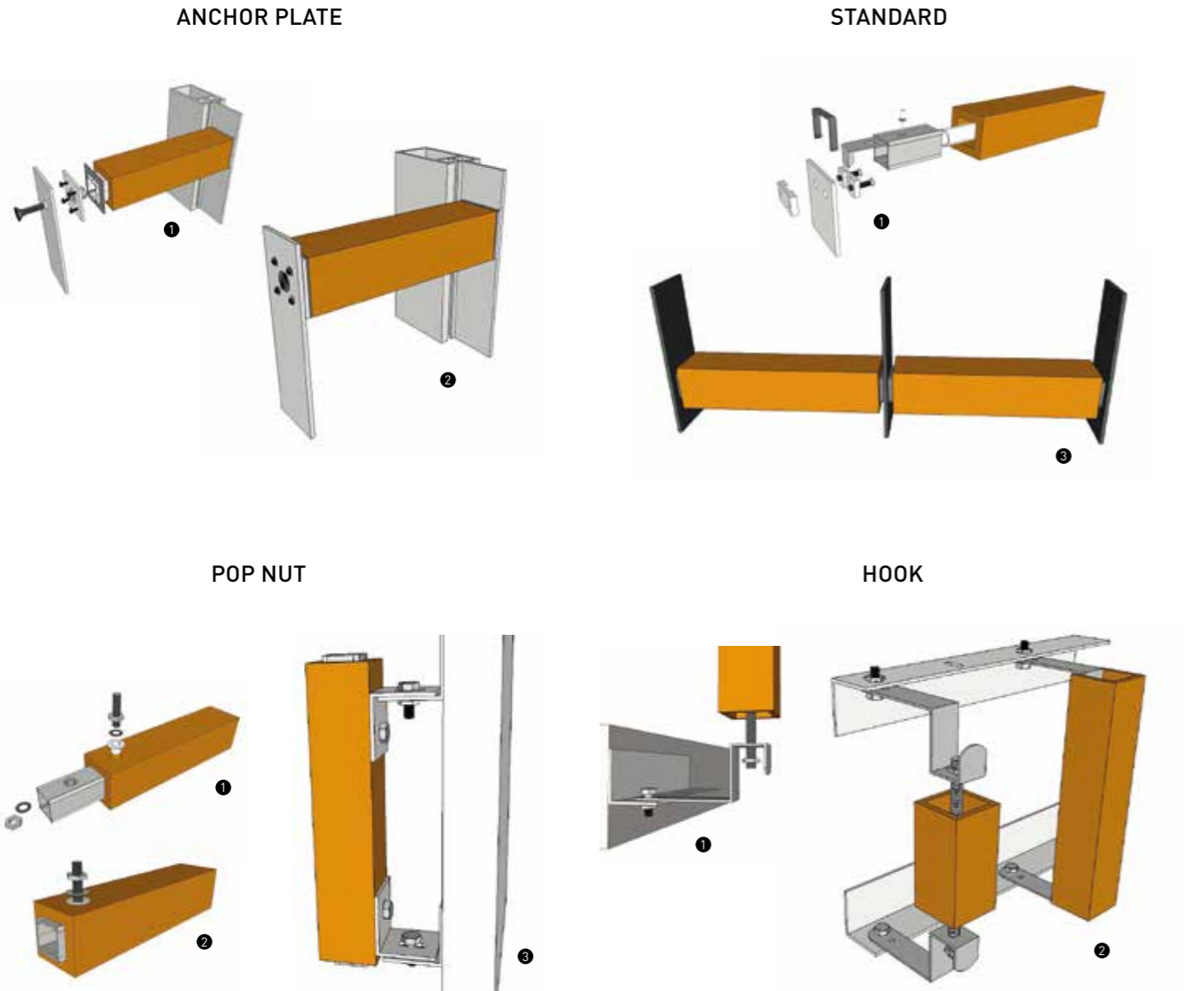

Piece/Pieza	B-d50	B-d110	B-5x5	B-6x6	B-7x7	B-5x5 curvo	B-5x8 r50	B-5x8
length piece/largo pieza - mm	< 1800	< 1800	< 1800	< 1800	< 1800	< 800	< 1800	< 1800
weight/peso - kg/metro lineal	2.5	9.2	3.5	4	5	3.5	5.5	5.5

Piece/Pieza	B-5x13	B-6x25	BO-160x50	BO-300x62	BO-200x50	B-32x80	BR0-49x75	BGR-28x150
length piece/largo pieza - mm	< 1800	< 1800	< 1800	< 1800	< 1800	< 1800	< 1800	< 1500
weight/peso - kg/metro lineal	7.7	15	7.6	17.5	9.7	4.5	5.5	6

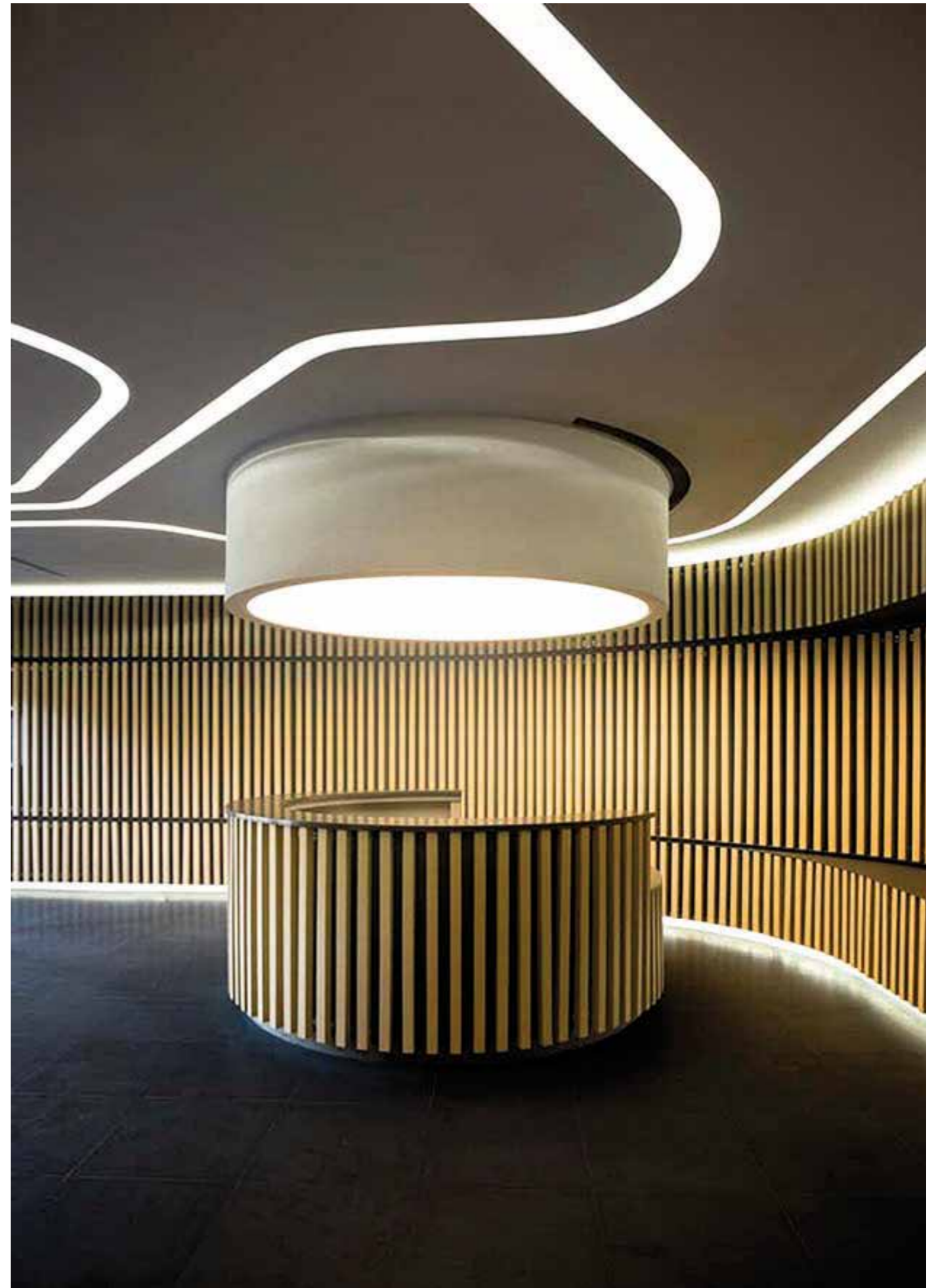

tempio® [projects] Príncipe de Vergara, Spain





PROJECT  
Mall L'Fort  
LOCATION  
Suwon, South Korea

PIECE



COLOURS

- Grey GR1-13
- Grey GR2-20
- Red R15-10
- Red R25-25

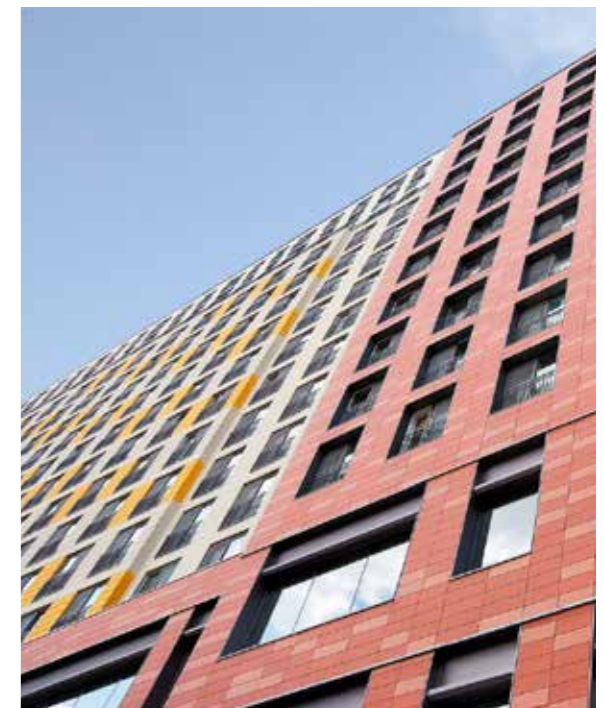



PROJECT  
Midtbyens Gimnasium





LOCATION  
Viborg, Denmark

PIECE



B-5x5

COLOURS

-  Red R15-10
-  Red R25-19
-  Red R25-25
-  Brown BR02-08

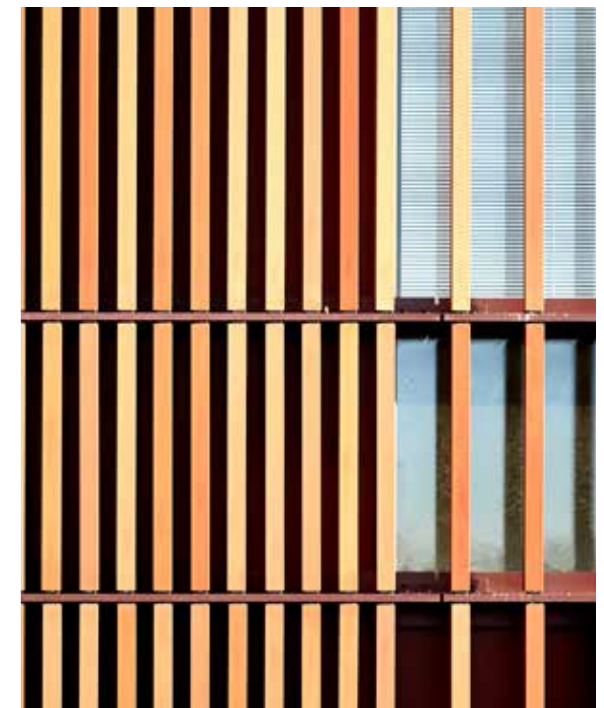



**PROJECT**  
St John Catholic Primary School

**LOCATION**  
Shepherd's Bush, London W12 7QT, Reino Unido





**ARCHITECT**  
DHP Property Consultant

**PIECE**



B-5x5

**COLOURS**

-  Yellow Tanzania EB3660
-  Yellow Angola EB3680
-  Red Murano EB3550
-  Blue Volga EB3315
-  Green Surrey EB3460





**PROJECT**  
Monarch

**LOCATION**  
Mosman, Australia

**ARCHITECT**  
Bates Smart

**PIECE**



B-5x5

**COLOURS**



Red R05-05



# COLOURS



# COLOURS

## NATURAL COLOURS COLORES NATURALES



## MAT ENAMEL ESMALTE MATE



## SATIN ENAMEL ESMALTE SATINADO



## GLOSS ENAMEL ESMALTE BRILLO

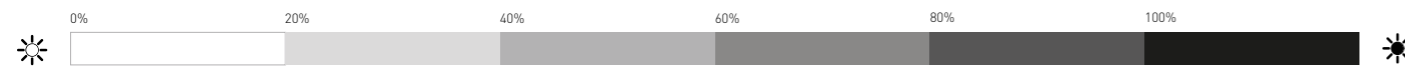
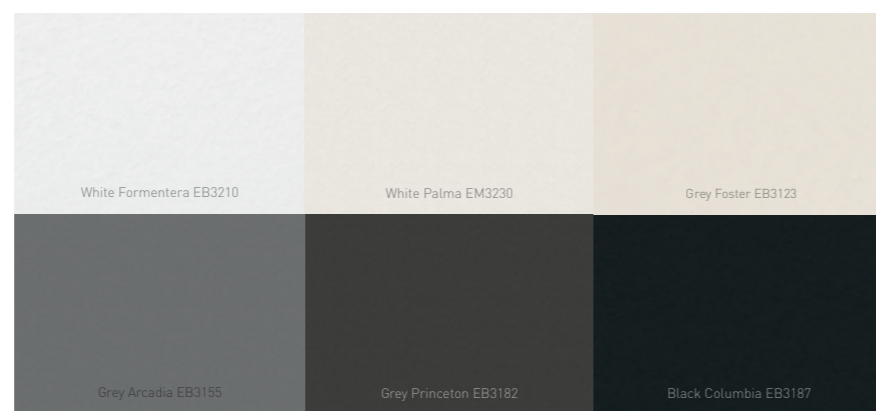

NEUTRAL GRADIENT SCALE  
ESCALA DE COLORES NEUTROS



COLOUR SCALE  
ESCALA DE COLOR

# INKJET COLOURS

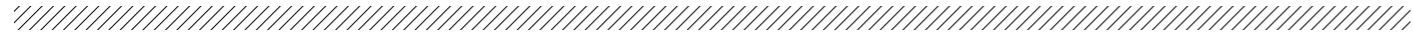

Amazonia Miel



Amazonia Café



Travertino



Sea Rock Caramel



Amazonia Canela



Calacatta Grey



Anthracite



Red FLamed



Woods Nordic



Woods Olivo



Canyon Cal



Canyon Creme



Stromboli Light



Stromboli Silver

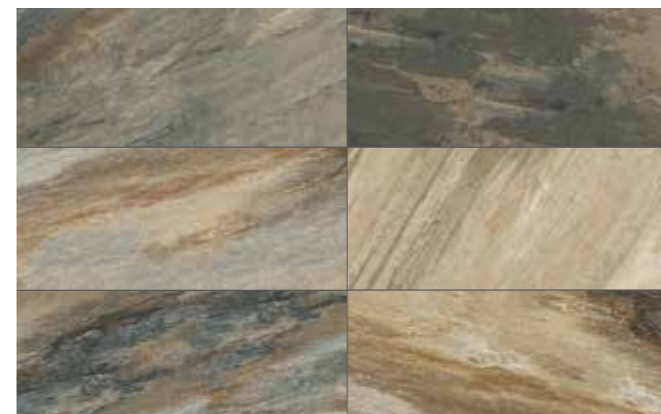

Canyon Mix



EK1006 BLACK & WHITE



**PROJECT**  
Grans Bryggeri

**LOCATION**  
Suecia

**ARCHITECT**  
Vision Architects

**PIECE**



FS-20

**COLOURS**

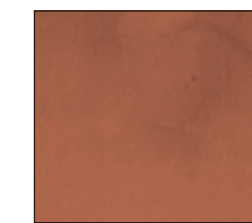

Red Flamed EK1005







**PROJECT**  
Flynn Flats

**LOCATION**  
Canada

**ARCHITECT**  
Vision Architects

---

**PIECE**



FS-16

---

**COLOURS**



Canyon Cal





PROJECT  
The Dilon  
LOCATION  
Canada  
ARCHITECT  
Vision Architects

PIECE



FS-16

COLOURS



Black & White EK1006





PROJECT  
Monaghan

LOCATION  
Canada

ARCHITECT  
Vision Architects

PIECE



FS-16

COLOURS



Canyon Cal





PROJECT  
Ed Data Company

LOCATION  
Denmarc

ARCHITECT  
Vision Architects

PIECE



FS-16

COLOURS



Stromboli light





tempio® [projects] Saukonkanava, Helsinki, Finland.



CERÁMICA MAYOR, S.A.  
 Partida Planet, s/n. 03510 Callosa d'En Sarrià (Alicante-España)  
 T+34 965 881 175 | www.ceramicamayor.com



## TECHNICAL INFORMATION | INFORMACIÓN TÉCNICA

 Customized designed substructure  
 Subestructura especialmente diseñada

 Profiles with hollow chambers  
 Perfiles con cámaras huecas

 Wide range of formats  
 Amplia gama de formatos

 Glazed and natural colours  
 Colores naturales y esmaltados

 Impact strenght  
 Resistencia al impacto | EN ISO 10545-5  
 ✓

 Water absorption  
 Absorción de agua | 0,5% <-< 4%  
 2% <-< 7%

 Frost resistance  
 Resistencia a la helada | EN ISO 10545-12  
 ✓

 Thermal shock resistance  
 Resistencia al choque térmico | EN ISO 10545-9  
 ✓

 Dimensional tolerance  
 Tolerancia dimensional | EN ISO 10545-2  
 ✓

 Thermal expansion  
 Dilatación térmica | ✓

 Bending strenght  
 Resistencia a la flexión | EN ISO 10545-4  
 >17N / mm<sup>2</sup>



CERÁMICA MAYOR, S.A.

Dirección: Partida Planet, s/n. Callosa d'en Sarrià, Alicante, España (03510)

Centro logístico: Polígono Industrial Supoi 8, Av. Boverot, 6, 12550 Almassora, Castellón

Teléfono: +34 965 881 175

Web: [www.ceramicamayor.com](http://www.ceramicamayor.com)

e-mail: [info@ceramicamayor.com](mailto:info@ceramicamayor.com)

Cerámica Mayor se reserva el derecho de hacer las modificaciones que considere oportunas. Los productos están en continuo desarrollo por lo que pueden tener modificaciones en las especificaciones técnicas. Debido a los procesos de impresión, los colores que aparecen en este catálogo deben considerarse aproximados, no exactos. Toda la información de este catálogo está protegida por copyright. Está prohibida la reproducción total o parcial de los textos, imágenes y representaciones gráficas sin la autorización expresa de Cerámica Mayor.

tempio®

VENTILATED FAÇADES  
FACHADAS VENTILADAS

EDITION - 2021

Mayor tempio®  
CERÁMICA

CERÁMICA MAYOR, S.A.  
Partida Planet, s/n. 03510 Callosa d'En Sarrià (Alicante-España)  
T+34 965 881 175 | [www.ceramicamayor.com](http://www.ceramicamayor.com)

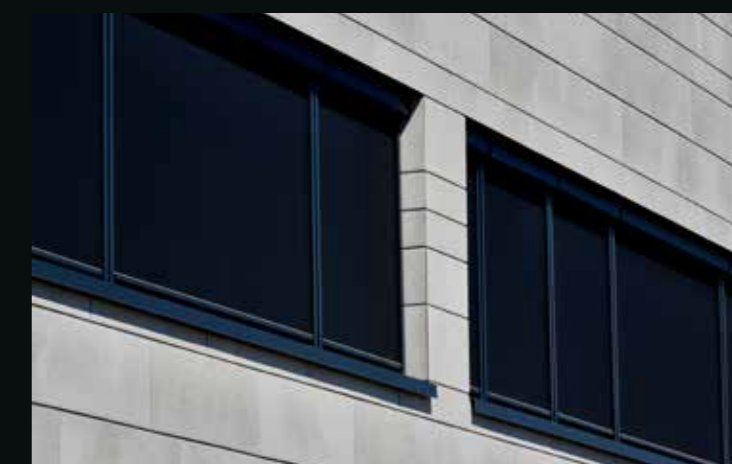

[www.tempio.es](http://www.tempio.es)